

Tools required for the Assembly

MEASURING TAPE PENCIL HACKSAW PLIERS SCREWDRIVER DRILL DRILL BITS 4mm + 6mm



Components Description

Figure 1-2

- A) Screen CartridgeHeader
- B) Pull Bar
- C) Side Track
- D) Top Track H 36 mm
- E) Bottom Track H 25 mm (to floor)
- F) Assembly notice+ Use and Maintenance
- G) RH + LH End Caps for Pull Bar
- H) Closing match
- I) Screws for Closing Match H
- J) Screen CartridgeHeader End Cap
- K) Screw for End Cap
- L) Screws kit + plugs for fixing
- M) Handle 1
- N) Handle 2
- O) Handle 3
- P) Screws for handles M+N+O
- Q) Top Track Support – made by 2 pcs
- R) Closing hook – made by 2 pcs
- S) Screw for hook R and support
- T) Cone Spring
- U) SupportHeader
- V) Speed Reduction Mechanism (Brake)
- X) Header with spring mechanism (Figure6)

STEP 1

Measure the height of the door opening, size "H" (Figure 3) example mm 2000



STEP 2

Take the Screen Cartridge Header (A) +net pipe and Pull Bar (B) + Side Track (C)

Mark the exact cutting point by using the measuring tape and the formula:

H – 13 mm keeping the mounted Header (X) as the 0 point of your measuring tape

(Figure4-5) example:2000 – 8 = 1987 mm

Align the profiles (A+B+C) on the cutting side (Figure4). On the opposite side, the one with header (X) already installed, the guide (C) will be 13 mm longer. (Figure 6). This difference will be compensated with the plastic components that will be assembled later on. Cut the profiles at the same time at the exact measure you calculated.(Figure7)

Check the size and clean the cut.(Figure7)

IMPORTANT: do not remove the Header (X), as it holds in place the spring mechanism that makes the insect screen work

STEP 3

Take the Brake (V) and the End Cap (J) from the accessories box; enter the Brake (V) on the pin of the End Cap (J) by rotating it.(Figure 8-9)

Enter the unit into the net pipe and fix firmly with the screws (K) supplied. (Figure 10-11)

Remove the brushweatherstrip from its housing on the Pull Bar (Figure 12)

Take the component Closing Match (H) and place it on the Pull Bar (Figure 13-14)

Follow the scheme to obtain a comfortable position: bend your arm 90° and measure the height from your hand to the ground (example 110cm)

Take the drill, drill with a 4mm bit in correspondence of the holes on component (H), fix with the screws(I) supplied.(Figure 14-15-16)

Re-enter the brushweatherstrip you removed from the Pull Bar. When it touches the component (H), cut off the exceeding length (Figure17).

Fix the End Cap (G) on the Pull Bar. (Figure17/B)

Repeat the steps on the opposite side to complete the assembly of the Pull Bar.

Take the cone spring (T) and place on the Support Header (U) with the largest size facing the Screen Cartridge Header. Attach them to the Screen Cartridge Header. They will be both used in a following step. (Figure18-18/B)

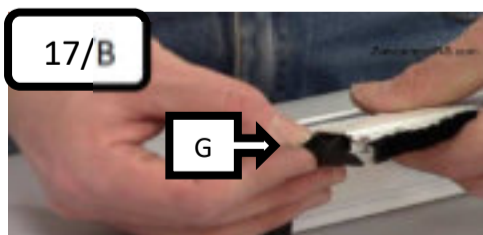

Step 5

Measure the width height of the door opening, size "W" (Figure 19) example: mm 1300

Step 6

Take the Tracks D (H 36 mm) and E(H 25 mm), align the brushweatherstrips and the tracks themselves (Figure 20).Mark the exact cutting point by using the measuring tape and the formula:

W – 50 mm (Figure21) example: 1300 – 50 = 1250mm

Cut and clean the profiles. Pinch the track end you cut in correspondence of the brushweatherstrip housing. Do it on both tracks. (the brushweatherstrips must not move while you use the insect screen Figure 22).



Watch the complete Assembly Video



Follow us on our website

WWW.ZANZARIEREIRS.COM

Assembly Notice for mod. PREMIUM/SUNOX Horizontal Door

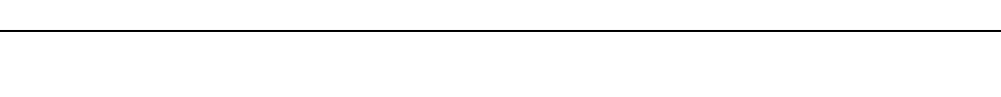
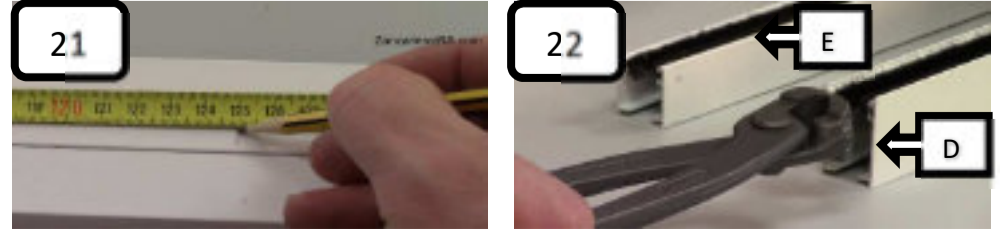
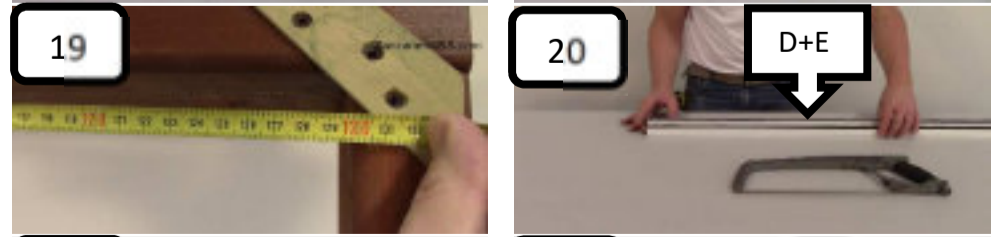
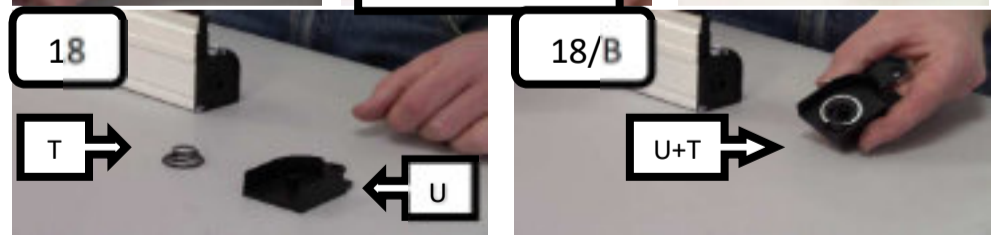
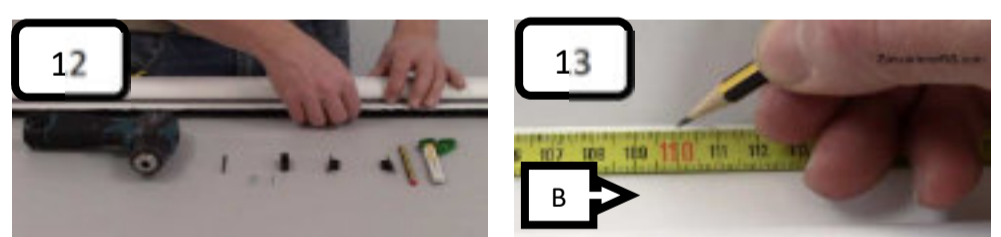
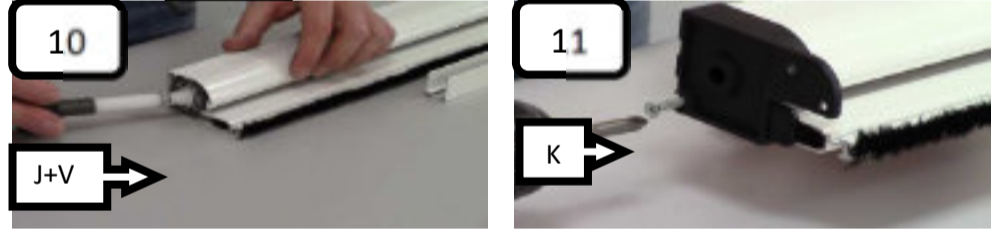
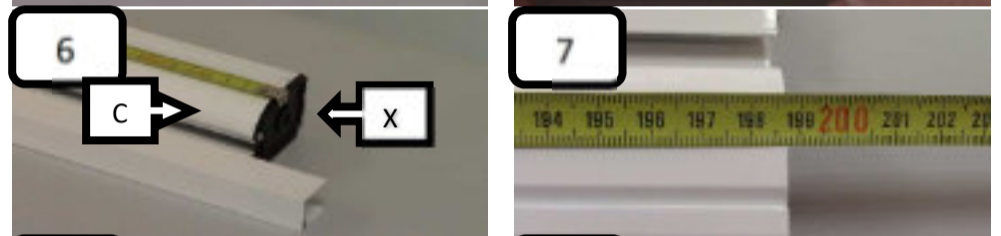
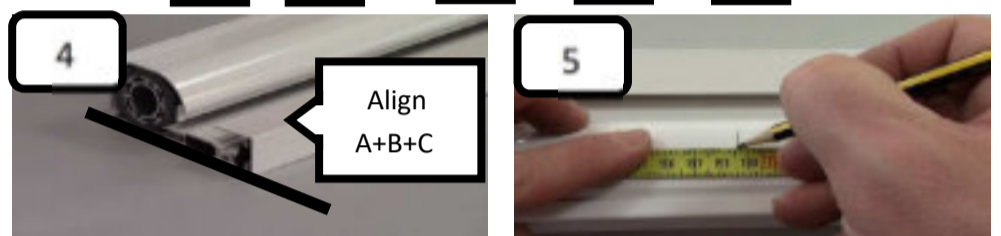
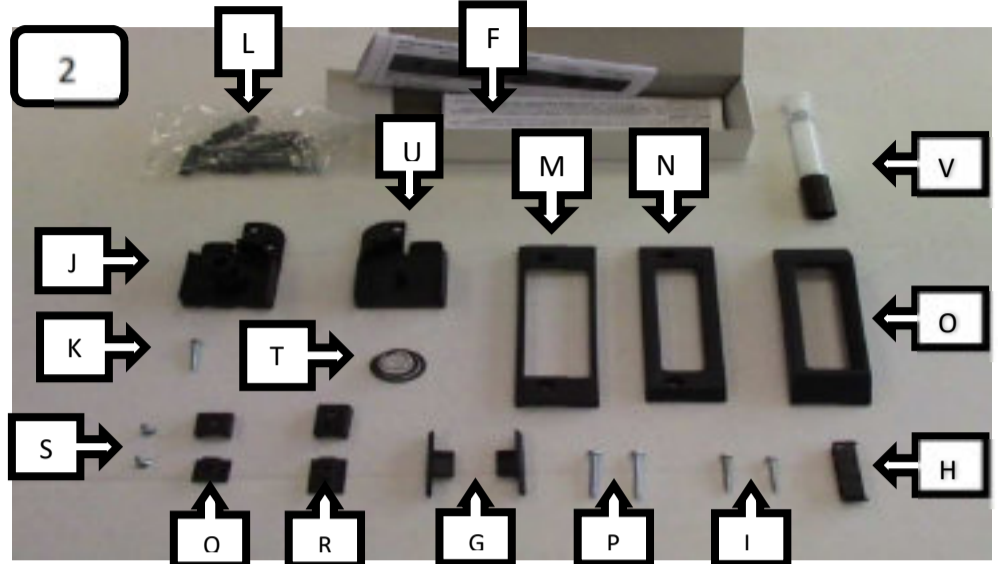

Step 7

Take the previously cut Track(C) (STEP 2)
 Check it is cut at the H size of the door opening, then divide its height by 3. Mark the 2 points you obtained and drill with a 4mm bit (Figure 23).
 Take the components Top Track Support (Q) and Closing Hook (R) + relevant screws (S).(Figure 24)
 Enter the flat part of component (R) in the Track (C) housing and place the part with the hook (R1) on top of it, then fix with screw (S)(Figure 25-26). Do not fix firmly, but move the unit to the center of Track (C).
 Following the same assembly method, enter the flat part of component (Q) into the Track (C) and place the part (Q1) on top of it, then fix with screw(S).(Figure 27). Do not fix firmly but move the unit downward of about 30 cm.

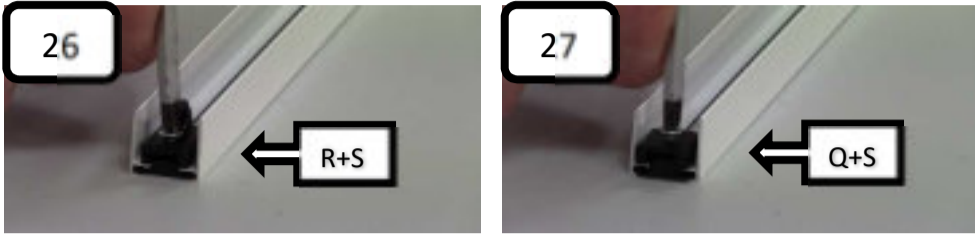

STEP 8

Place the Screen Cartridge Header (as mounted in STEPS 2-3-4)inside the door jamb (Figure28). Lay the Screen Cartridge Header in the ground and, pressing against the Screen Cartridge Header, the top side should slide toward the corner of the opening (Figure 29)until it adheres perfectly to the walls.
 Check the Screen Cartridge Header is inserted correctly, that is parallel to the edge of the opening at a constant distance and touching the vertical wall of the opening (see scheme 28A). Fix the Screen Cartridge Header into the door opening using the screws supplied component (L). In case fixing with wall plug is needed, drill with a 6mm bit (Figure 30-31-32-33).

STEP 9

Measure the distance between the Screen Cartridge Header and the sill (Figure 34).
 Take the Track(C)and fix it on the opposite side to the Screen Cartridge Header, making sure you respect the measures you checked (Figure34) between sill and Screen Cartridge Header and between sill and Track (C) (Figure 35).
 Fix the Track using the holes you drilled (STEP 7 Figure 23) and fix with the screws supplied, if needed you can use the plugs by drilling with a 6mm bit. (Figure 36-37)

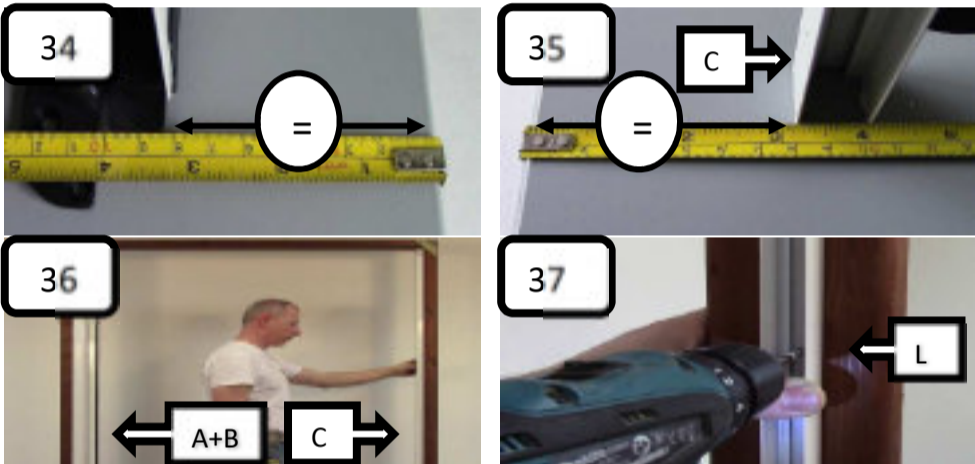

STEP 10

1) Take the Track (E) to be laid on the floor (H 25 mm). Slightly open the insect screen by pulling the Pull Bar and enter the Track (E) into the appropriate appendage placed on the bottom of the Screen Cartridge Header (Figure 38). The other end of the Track (E) has to be entered inside the Track (R) (Figure 39).
 2) Take the Track (D) to be seated on the architrave (H 36 mm). Slightly open the insect screen by pulling the Pull Bar and enter the Track (D) into the appropriate appendage placed on the top of the Screen Cartridge Header (Figure 40). The other end of the Track (E) has to be entered inside the Track (R) (Figure 41).

Undo the screw formerly fixed on the unit Q+S(STEP 7 Figure27) so that the unit can move inside its aluminum housing, place the support under the Top Track to hold it, than fix it firmly.(Figure 42-43)

STEP 11

Take the Handle 1 (M), lay it on the Pull Bar, paying attention in it has a larger and a smaller side so that it can adhere perfectly to the Pull Bar (Figure 44). Check the position of the previously mounted component (H), place component (M) so that component (H) is at its center(Figure 44). Mark the drilling point using component (M) as a mask,drill a passing-through hole with a 4 mm bit (Figure 45).
 Take the component (M) to be superposed to component (N) (Figure 46) and place them on the external side. (Figure 47)
 On the internal side of the Bar, place component (O), paying attention in it has a larger and a smaller side so that it can adhere perfectly to the Pull Bar (Figure 49). Fix with the screws (P) supplied.(Figure 50)

STEP 12

Put the Pull Bar (B) close to the Track(C). So that item (H) hooks on the unit(R+S). (Figure 51-52)
 Adjust the position of the unit (R+S), keeping in mind that In order to hook the 2 items you have to follow this scheme:
 1) Raise up Bar (B)
 2) Move it against Track (C)
 3) Lower Bar (B)

Fix firmly only when the two parts hook perfectly.

(Figure 53)

Move back the Pull Bar against the Screen Cartridge Header.

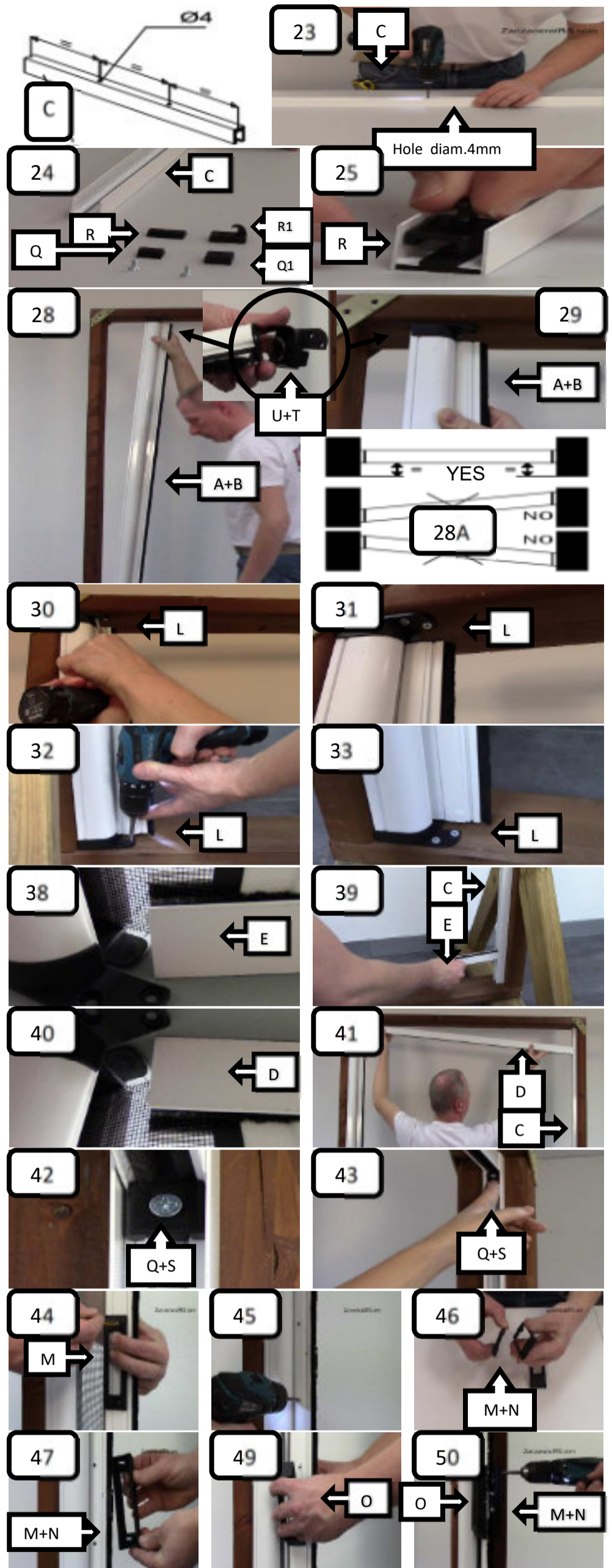
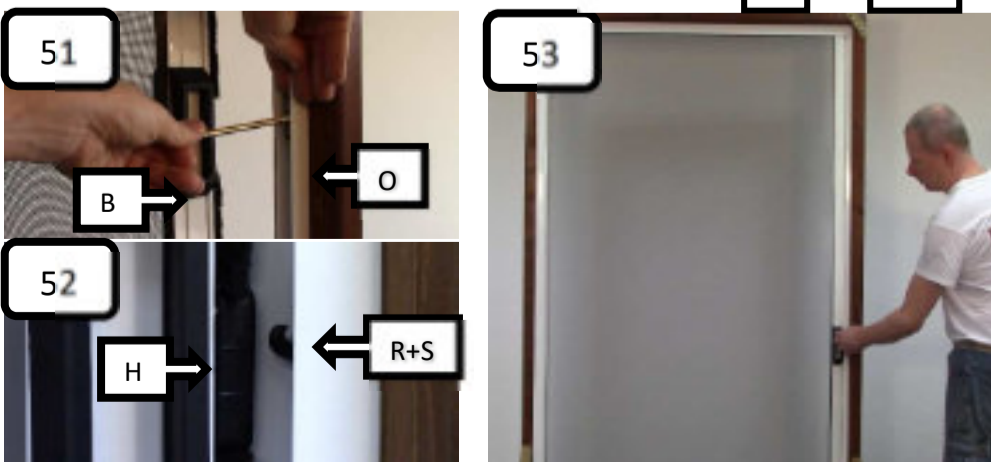

CLEANING AND MAINTENANCE

The product only requires a regular cleaning.
 The cleaning of the insect screen must be carried out at the user's discretion depending on the conditions of use, presence of fumes, vapors, presence of pollen, etc. We recommend cleaning the net at least every 2 months, from the beginning of spring before use until the end of use. It is recommended to use specific products that clean and sanitize the net without damaging it such as "ALVARO SPRAY" and other specific products of the "ALVARO" line specifically designed for our mosquito nets. To clean the aluminum structure, use neutral detergents or a damp cloth

Produced by IRS SPA
 Via Vettigano 20/A
 42012 Campagnola Emilia
 Reggio Emilia Italia
www.zanzariereirs.com
 Manufactured in Italy